

Golden Manor, W7

Approximate Gross Internal Area = 77 sq m / 829 sq ft

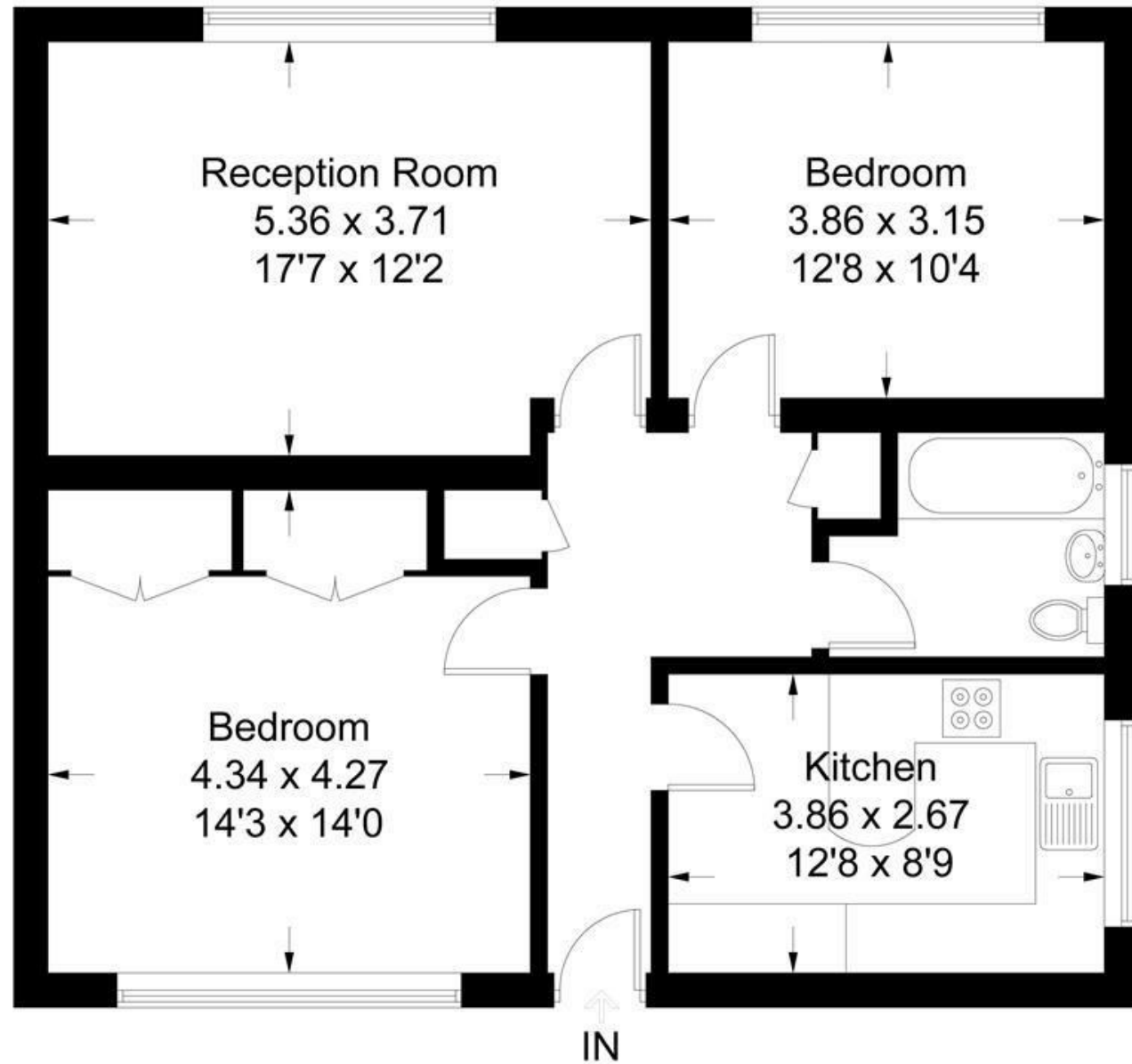

FLAT

Golden Manor W7
£1,350

FEATURES

- Close to station
- Double garage
- Communal gardens
- Two double bedrooms
- Allocated off street parking
- Furnished or Unfurnished

Measured in accordance with RICS Code of Measuring Practice. To be used for identification and guidance purposes only.
Whilst every care is taken in the preparation of this plan, please check all dimensions, shapes and compass bearings before making any decisions reliant upon them.
www.london58.com © 2021 hello@london58.com

FLAT

Golden Manor W7

£1,350

This exceptionally large two double bedroom flat is set in one of the most prestigious roads in Hanwell, an idyllic part of West London located near the tranquil banks of the River Brent and surrounded by green spaces as well as being just moments from Hanwell Station.

The flat itself has a large bright living area, two double bedrooms and an eat in kitchen with plenty of workspace and storage. There are also the additional benefits of an allocated parking space, a double garage and communal gardens

